

PRODUCT NUMBER

71600-YXXLF

- LEAD FREE, SEE NOTE 6
- TOTAL NB OF POSITION 04 TO 64
SEE SHEET 2
- OPTIONAL STRAIN RELIEF
SEE SHEET 2

TRIANGLE INDICATES
POSITION 1
NOTE 5

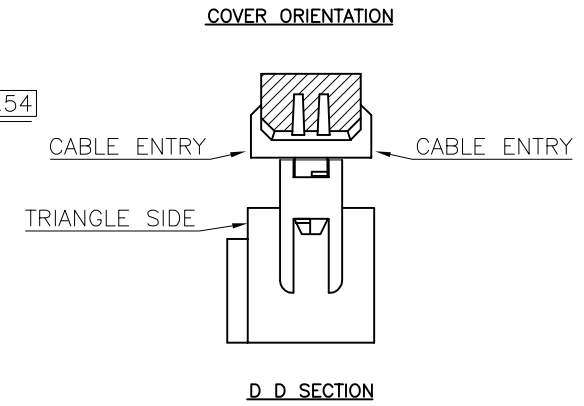
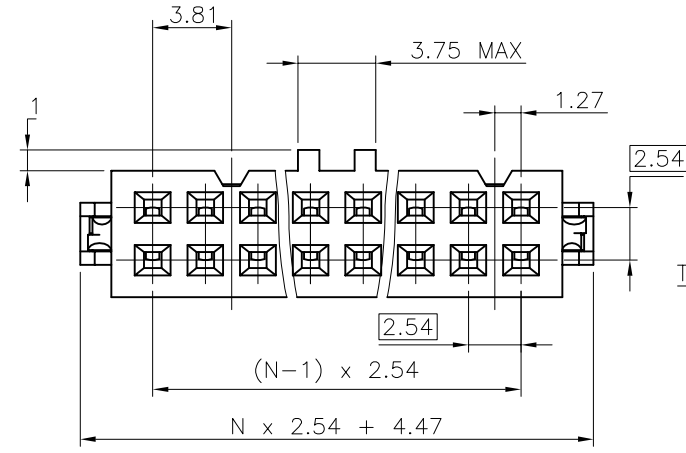
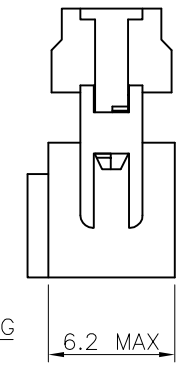
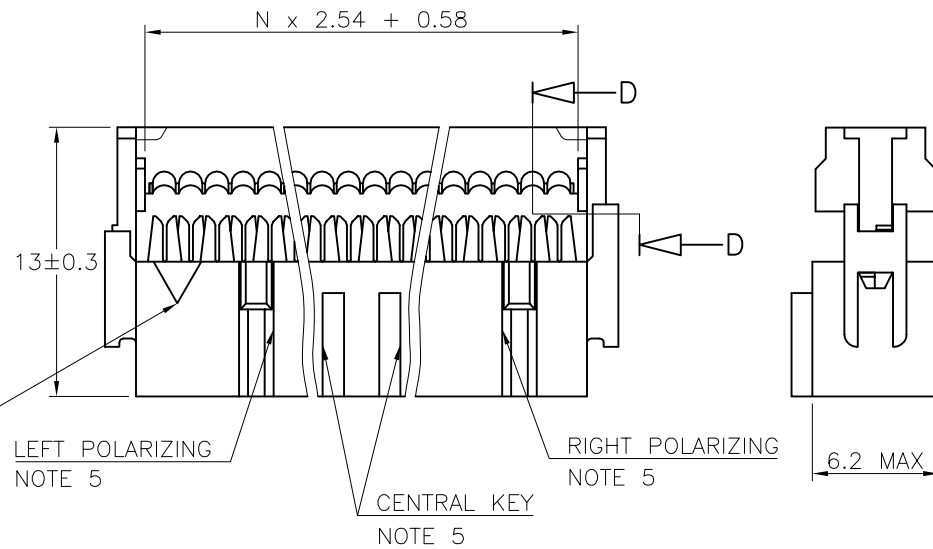

NOTES:

- 1 - PLASTIC MAT'L : GLASS FILLED HIGH TEMPERATURE THERMOPLASTIC. UL94V-0 COLOR: GREY
- 2 - PIN MATERIAL : PHOSPHOR BRONZE
- 3 - PRODUCT PACKAGED IN TUBES.
- 4 - TO DETERMINE DIMENSIONS :
N = NUMBER OF POSITIONS
EXAMPLE : 8 POS N x 2.54 = 20.32mm
- 5 - 2x5, 2x6, 2x7 HAVE NO LEFT POLARIZING SLOT.
- 2x2, 2x3 WITH CENTRAL KEY HAVE NO TRIANGLE, NO LEFT AND RIGHT POLARIZING SLOT.
- 2x2 WITHOUT CENTRAL KEY HAS NO LEFT AND RIGHT POLARIZING SLOT.
- 2x3, 2x4 WITHOUT CENTRAL KEY HAVE NO LEFT POLARIZING SLOT
- 2x4 WITH CENTRAL KEY HAVE NO LEFT AND RIGHT POLARIZING SLOT
- 6 - THIS PRODUCT MEETS EUROPEAN UNION DIRECTIVES AND OTHER COUNTRY REGULATIONS AS PER GS-22-008.
PACKAGING SPECIFICATION AS PER GS-14-920.

mat'l. code SEE NOTES		surface ISO 1302	tolerance ISO 406 ISO 1101	projection mm	product family 2.54MM IDC
ltr	ecn no	dr	date	tolerances unless otherwise specified	title
AG	F04-0330	LMU	04.09.01	angles linear X.X ±0.3	QUICKIE III FEM 0.76µm Au
AH	F05-0109	JCO	05.01.17	X.XX ±0.13	
AJ	F05-0171	LMU	05.04.07	X.XXX ±0.05	scale 5:1
AK	F05-0180	LMU	05.04.22	dr D.LE 01.01.24	dwg no
AL	F06-0270	LMU	06.09.12	enrg P.NZ 01.01.24	sheet 1 of 2
AM	F06-0274	LMU	06.09.25	chr JF.N 01.01.24	size
AN	F09-0233	LMU	09.12.15	appd P.NZ 01.01.24	A3
sheet index	revision sheet	AN	AE		type
		1	2		CUSTOMER Drawing

CORE RANGE	
STRAIN RELIEF	Nbr OF POSITIONS
0/1	04
0/1	06
0/1	08
0/1	10
0/1	14
0/1	16
0/1	18
0/1	20
0/1	24
0/1	26
0/1	30
0/1	34
0/1	40
0/1	50
0/1	60
0/1	64
PLATING	
0.76µm GOLD ON CONTACT AREA	
1.27 µm Ni REMAINDER OF PRODUCT	

CATALOGUE RANGE	
STRAIN RELIEF	Nbr OF POSITIONS
2/6	04
2/6	06
2/6	08
2/6	10
2/6	14
2/6	16
2/6	18
2/6	20
2/6	24
2/6	26
2/6	30
2/6	34
2/6	40
2/6	50
2/6	60
2/6	64
PLATING	
0.76µm GOLD ON CONTACT AREA	
1.27 µm Ni REMAINDER OF PRODUCT	

624
304
204 / 224
004
DASHES NOT AVAILABLE

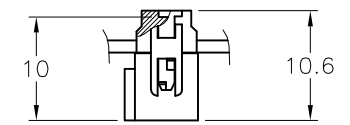

WITHOUT STRAIN RELIEF

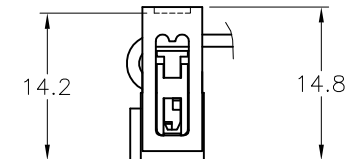

WITH LOW PROFILE STRAIN RELIEF

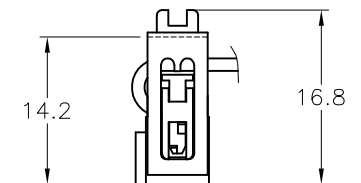

WITH STANDARD STRAIN RELIEF

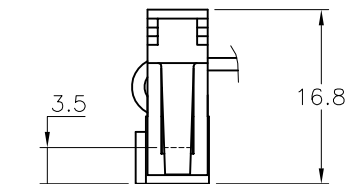

WITH LATCHING STRAIN RELIEF

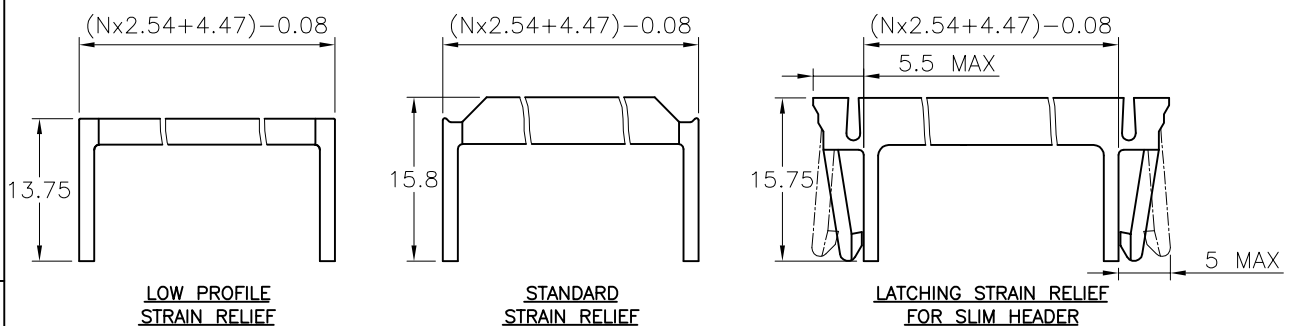

LOW PROFILE STRAIN RELIEF

STANDARD STRAIN RELIEF

LATCHING STRAIN RELIEF FOR SLIM HEADER

71600-6YYLF	●					●
71600-3YYLF		●	●			
71600-2YYLF	●				●	
71600-1YYLF	●			●		
71600-0YYLF	●		●			
PRODUCT NUMBER	WITH	WITHOUT	STANDARD	WITHOUT	LOW PROFILE	LATCHING
	CENTRAL KEY		STRAIN RELIEF			

mat'l. code		surface		tolerance		projection		product family	
		ISO 1302		ISO 406 ISO 1101				QUICKIE	
ltr	ecn no	dr	date	tolerances unless otherwise specified		mm		title	
X	F70666	AAN	97.11.05	angles	linear			IDC RECEPT	
Y	F10121	DLE	01.01.24			scale N/A		DR	
AA	F10199	GCO	01.04.26					sheet 2 of - size	
AB	F03019	DLE	03.01.23	dr	D.LE	01.01.24	71600		A3
AC	F05-0180	LMU	05.04.22	engr	P.NZ	01.01.24	71600		A3
AD	F06-0270	LMU	06.09.12	chr	JF.N	01.01.24	71600		A3
AE	F06-0274	LMU	06.09.25	appd	P.NZ	01.01.24	71600		A3
sheet index		revision sheet						type CUSTOMER Drawing	